

## New WcCare 130° support rail - Brushed stainless steel

Ref. 4295413 EAN Code. 5604815900385

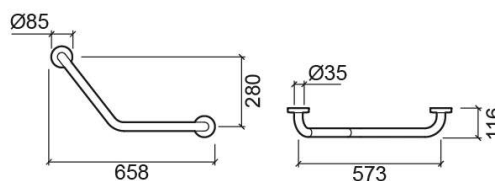

### Description

VAT at reduced rate (DL 163/2006 of 8 August 2006) ?  
Accessibility Act.

### Features

- Fixing kit included (for masonry walls)

### Technical Information

Length: 658 mm  
Width: 116 mm  
Height: 280 mm  
Weight: 1.57 kg

Collection: New WcCare

Product type: Reduced mobility

Material: Stainless steel

Installation type: Wall mounted

## Downloads

### Cleaning Manuals

[Cleaning Manual \(PDF\)](#) ,

### 2D & 3D Files

[42954 CAD 2D \(ZIP\)](#) , [42954 CAD 3D \(ZIP\)](#) ,

### Assembly Instructions

[42954 \(PDF\)](#) ,

### Technical Drawings

[42954 DT \(PDF\)](#) ,

