

New WcCare 90° support rail, left - Brushed stainless steel

Ref. 4296113

EAN Code. 5604815900408

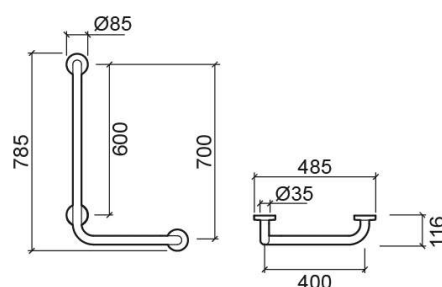

Description

VAT at reduced rate (DL 163/2006 of 8 August 2006) ?
Accessibility Act.

Features

- Fixing kit included (for masonry walls)

Technical Information

Length: 485 mm

Width: 116 mm

Height: 785 mm

Weight: 2.65 kg

Collection: New WcCare

Product type: Reduced mobility

Material: Stainless steel

Installation type: Wall mounted

Downloads

Cleaning Manuals

Cleaning Manual (PDF) ,

2D & 3D Files

42961 CAD 2D (ZIP) , 42961 CAD 3D (ZIP) ,

Assembly Instructions

42954 (PDF) ,

Technical Drawings

42961 DT (PDF) ,

