

Sanlife vanity unit with basin and tap hole - White

Ref. 69199100

EAN Code. 5604815911756

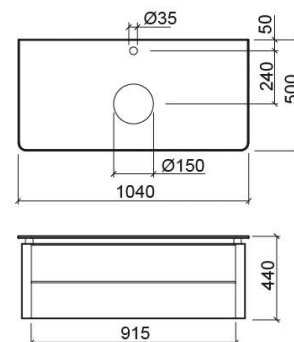

Technical Information

Length: 1040 mm

Width: 500 mm

Height: 440 mm

Weight: 59 kg

Collection: [Sanlife](#)

Product type: Vanity units

Style: Contemporary

Product Format: Rectangular

Material: Vanity unit - Lacquered MDF and melamine; Handles - Aluminium; Cover - 12mm synthetic ivory

Bowl position: Centre

Installation type: Wall hung

Features

- With 2 drawers
- With Smoove closing system
- Compatible with countertop basins without tap hole, with countertop taps
- Upper drawer with remover organisers
- Fixing kit included

Variations



Taupe and White
1040x500x440 mm

Ref. 69199102
EAN Code. 5604815911794
Weight: 59 kg

Downloads

Cleaning Manuals

Cleaning Manual (PDF) ,

2D & 3D Files

691991 CAD 2D (ZIP) , 691991 CAD 3D (ZIP) ,

Assembly Instructions

61970 IMO (PDF) ,

Technical Drawings

691991 DT (PDF) ,

